

Three-phase asynchronous motors for circular discs

1. Application

The motors from this series are used for circular discs for mechanical treatment of timber and wooden sheets and plates.

2. Technical Data

Degree of Protection - IP 54
 Duty Cycle - S6 40%
 Thermal Class of Insulation - F (155°C)
 Supply Voltage - 230/400V±10%, 50Hz, D/Y

3. Construction

The motors are produced in cast iron.

The motors are produced with an automatic thermo switch for 150°.

The terminal box can be mounted on the side (left or right) of the frame or on top of the body. The terminal box can be rotated at 90°.

The motor A90LX-2KSLB-14 is produced with an electromagnetic brake.

Stopping torque 10N.m
 Basic supply voltage of the brake electric magnet 98V
 Rated output of the brake electric magnet 50W

Technical Data Tables

TYP TYPE	Bemessungsleistung Rated output		Spannung Voltage	Betriebswerte bei Bemessungsleistung Parameters at rated output			Anlaufverhalten Starting performance			Gewicht Weight
	P1			n _N min ⁻¹	I _N A	cos φ	I _s A	M _s N.m	M _{MAX} N.m	
	kW	hp	U V							kg
3000min ⁻¹										
A90LL-2KS-11	5.5	7.5	230/400	2900	15.7/9.0	0.88	94/54	21	28.4	25
A90LL-2KS-17										
A90LL-2KSL-41										
A90LX-2KSL-13	5.5	7.5	230/400	2800	15.0/8.6	0.93	90/52	30	35	29.5
A90LX-2KSLB-14										34
A100LK-2KS-56	5.5	7.5	230/400	2820	16.9/9.7	0.82	101/58	30	35	29
1500min-1										
A90LL-4KSR-12	4.0	5.5	230/400	1250	11.0/6.3	0.92	66/38	40	43	26.5
A100LK-4KSR-55	4.0	5.5	230/400	1350	11.5/6.6	0.88	70/40	30	34	31
A100L-4KSR-20	4.0	5.5	400/690	1400	6.9/4.0	0.83	42/24	40	40	34.5
A100L-4KSR-75	5.5	7.5	230/400	1350	16.0/9.3	0.86	97/56	52	58	35.5
A100L-4KSR-167	6.0	8.0	230/400	1370	17.7/10.2	0.85	106/61	56	64	35
A100LX-4KSR-70	8.0	10.7	230/400	1350	23.7/13.6	0.85	143/82	70	78	40
A112M-4KSR-25	5.0	7.0	400/690	1420	8.5/4.9	0.86	51/29	50	60	41
A112MC-4KSR-254	10.0	13.5	400/690	1340	17.0/9.8	0.85	103/59	75	100	45

Overall and Joining Dimensions

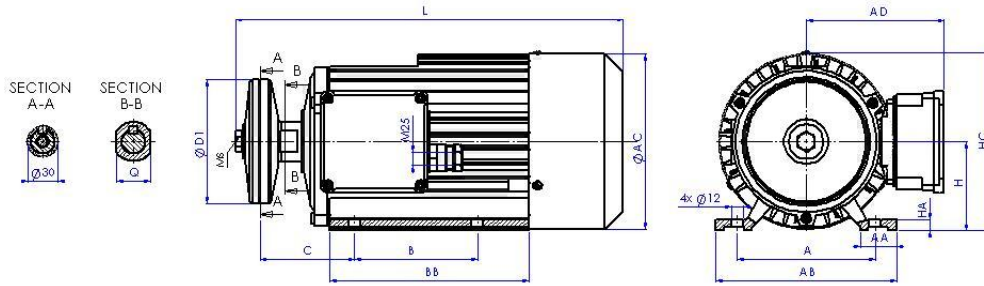

TYP TYPE	Ausßenabmessungen und Anbaumasse Overall and Joining Dimensions															
	A	AA	AB	AC	AD	B	BB	C	D1	H	HA	HC	HD	L	MS	Q
A90LL-4KSR-12	140	38	175	177	140	125	174	94	125	90	11	182	-	345	M12x40	34
A100LK-4KSR-55	160	45	200	192	155	140	200	102	150	100	17	196	-	368	M16x40	46
A100L-4KSR-20	160	45	200	192	155	140	200	102	150	100	17	196	-	398	M16x40	46
A100L-4KSR-75																
A100L-4KSR-167																
A100LX-4KSR-70	160	45	200	192	155	140	220	102	150	100	17	196	-	404	M16x40	46
A112M-4KSR-25	190	50	235	220	160	140	203	102	150	112	17	222	-	390	M16x40	46
A112MC-4KSR-254	190	50	235	220	160	140	223	102	150	112	17	222	-	410	M46x40	46

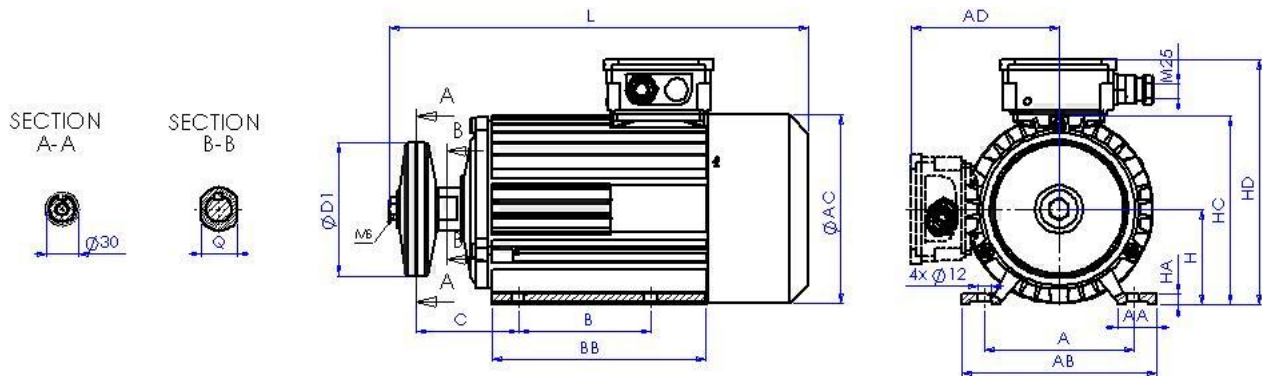

TYP TYPE	Ausßenabmessungen und Anbaumasse Overall and Joining Dimensions															
	A	AA	AB	AC	AD	B	BB	C	D1	H	HA	HC	HD	L	MS	Q
A90LL-2KS-11	140	38	175	177	-	125	174	94	125	90	10	182	230	345	M12x40	34
A90LL-2KS-17	140	38	175	177	-	125	174	94	125	90	10	182	230	345	M12x40LH	34
A90LL-2KSL-41	140	38	175	177	140	125	174	94	125	90	10	182	-	345	M12x40LH	34
A90LX-2KSL-13	140	38	175	177	145	125	204	94	125	90	10	182	-	375	M12x40LH	34
A90LX-2KSLB-14	140	38	175	177	145	125	204	94	125	90	10	182	-	404	M12x40LH	34
A100LK-2KS-56	160	45	200	192	155	140	200	102	150	100	17	196	-	368	M16x40	46